

# BB-02: Sonobuoy Launcher / CPI for CH124A

Kit: Hasegawa Sea King 1/48

**Belcher Bits**  
33 Norway Spruce Street, Stittsville, ON, Canada K2S 1P3  
Phone: (613) 836-6575, e-mail: info@belcherbits.com

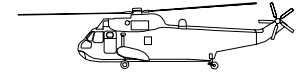

## Background

Around 1980, all Canadian CH-124A Sea Kings were fitted with a fuselage mounted sonobuoy launching system which can accommodate both flares and sonobuoys. Externally, it appears as a number of open tubes protruding from the bottom of the aft fuselage. At about the same time, Sea Kings were fitted with a Crash Position Indicator (CPI), a transponder designed to break away from the aircraft and emit a homing signal in case of a crash. It is mounted on a plate fixed to the aft starboard side of the tailboom.

**CPI Assembly Instructions:** Cut a piece of the 0.010" sheet supplied, 0.45" square. Roll it over a paintbrush handle to give it a slight curve, and glue it into position as shown on the sketch. Sand the backing from the resin CPI and using cyanoacrylate, glue it into position in the centre of the sheet, with the small dot up. Use your favourite filler to form a smooth fillet all around the CPI. When painting, the top half of the inverted piepan shaped part is painted red, the bottom white; the rest is the same colour as the airframe.

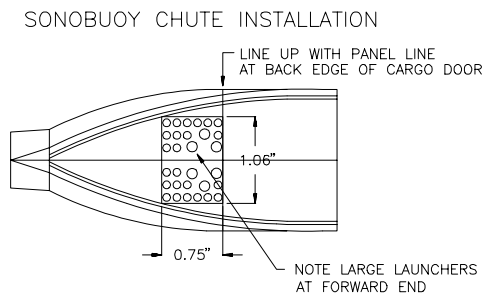
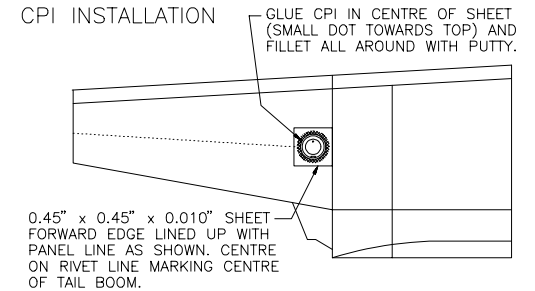

**Sonobuoy Launcher Assembly Instructions:** Because this piece spans the entire bottom of the fuselage, it is easier to finish the basic fuselage construction first, then carve a square hole where indicated and fit it in. Once glued in place with cyanoacrylate (be careful not to get any in the holes!), it should be filed and sanded flush with the bottom. This is the time to prime and check seams, before adding the tubes!

**Sonobuoy Launch Tubes:** Two sizes of aluminum tubing are supplied for you to construct your launcher tubes. The launcher tubes are cut away on their aft sides as shown in the sketch below. In order to produce these, a fixture is supplied to assist in getting all 24 small and 6 large tubes the same size and shape. The tubing fits in the slot as shown, and using a file, you remove one side down to the level of the base. Don't apply too much pressure or the tubing will distort. Also, the file will remove material from the fixture as easily as from the tubing, so try to be careful near the end of the cut, or your fixture will become worn and your last tubes will not resemble your first! After filing, cut the tube to length using the indicated slot. When installing the tubes in the launcher, ensure they **all** point **straight** down! They fit fairly snugly in the launcher, so you should be able to position them well and then apply a small amount of cyanoacrylate to hold them in position. The tubes are painted the same colour as the airframe.

## USE OF TUBING FIXTURE

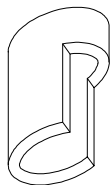
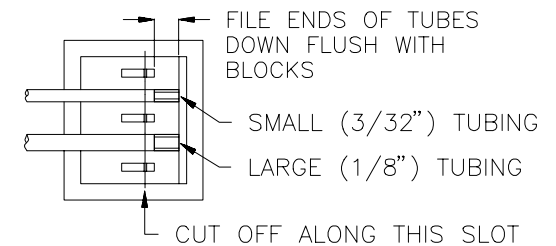

SONOBUOY CHUTE  
OPEN SIDE FACES AFT

## Other Construction Notes:

1. Don't forget that the short sponsons and radome as given in Belcher Bits Set BB-01 will be required.

## References

1. IPMS Canada **RT** Vol 15 No.3: Interior views and colour schemes of CH-124s
2. IPMS Canada **RT** Vol 16 No.6: Detail pictures of CPI and launcher, updated colour schemes
3. **Famous Airplanes of the World No.15** Sikorsky Sea King, Burindo Co.: Not much on CH-124s, but if you like Sea Kings, you should have this book